

FOR LEASE: RETAIL/FLEX SPACE AVAILABLE

4,000 SF - 8,000 SF

914 Canal Street | Northern Liberties | Philadelphia, PA

EQUITY CRE



PROPERTY HIGHLIGHTS

- 4,000-8,000 SF available
- 17' ceilings
- 14' overhead door
- Zoning: CMX-2
- Located in Northern Liberties
- Two blocks from Spring Garden Street and just minutes to 2nd Street's vibrant dining corridor
- Easy access to I-95 and the Delaware River waterfront
- Surrounded by brand new residential developments

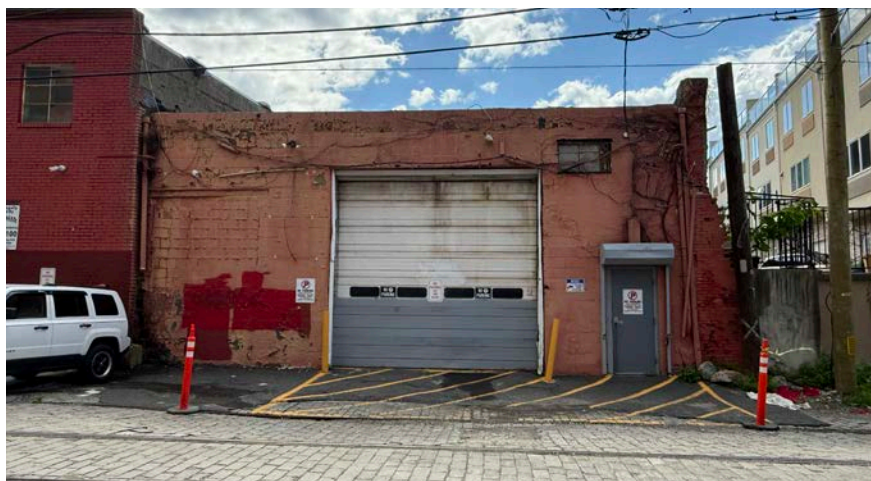

CONTACT

STEVE JEFFRIES

sjeffries@equitycre.com

DIRECT 484.531.2250

NATHAN RHODES

nrhodes@equitycre.com

DIRECT 484.531.2076

CHRIS MUNDIATH

cmundiath@equitycre.com

CELL 610.772.4746

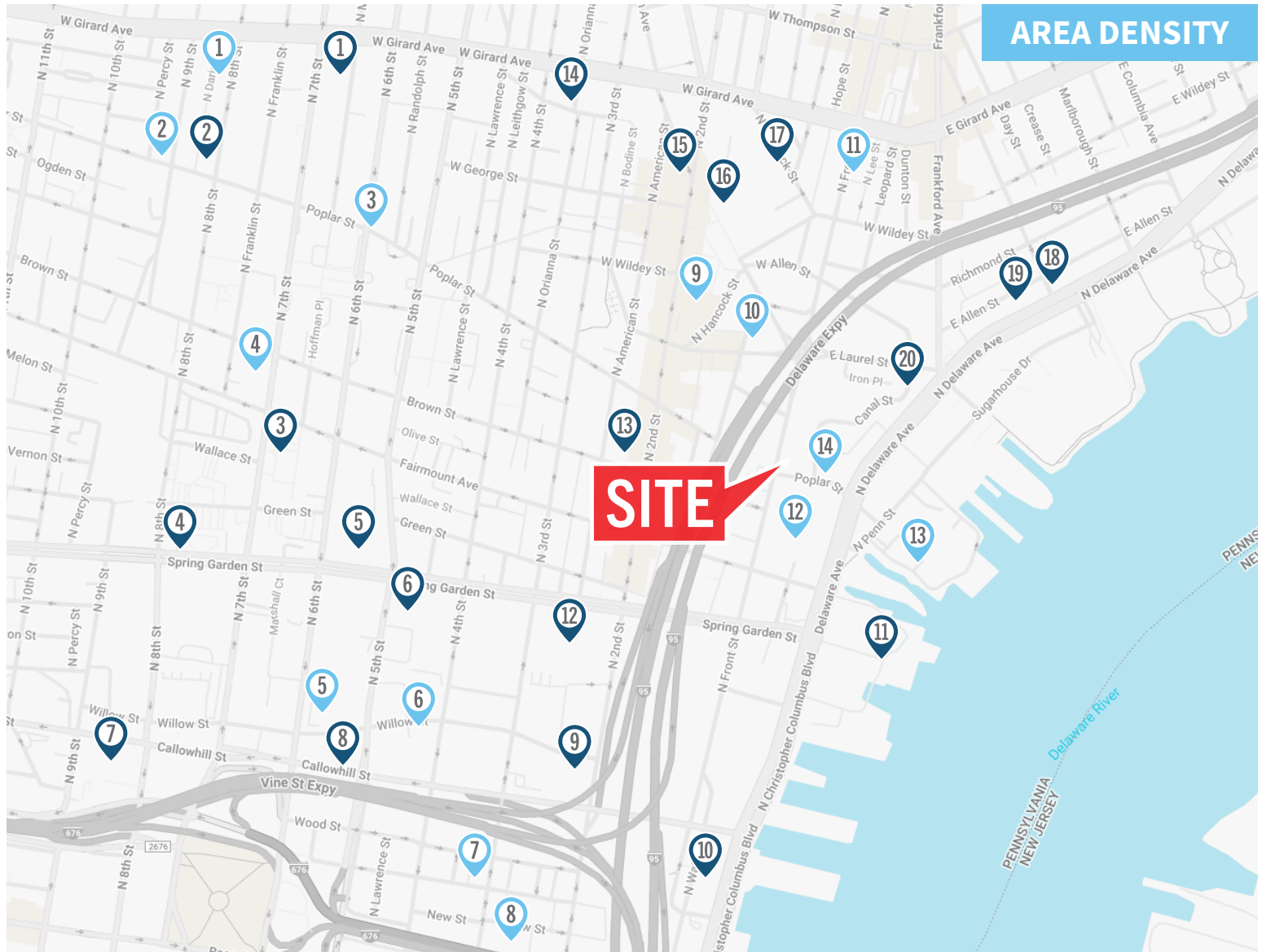
FOR LEASE: RETAIL/FLEX SPACE AVAILABLE**4,000 SF - 8,000 SF****914 Canal Street | Northern Liberties | Philadelphia, PA****EQUITY CRE****EXISTING RESIDENTIAL**

	Address	Units
1	North Eighth Park	24
2	The Poplar	285
3	The Randolph	40
4	Liberties West Condos	172
5	SoNo	49
6	444 Lofts	136
7	York Square	60
8	The Chocolate Works	135
9	The Piazza	656
10	Ironworks	49
11	The Magnet	43

12	1 Brown Street	224
13	Waterfront Square	484
14	Five on Canal	462

PROPOSED/UNDER CONSTRUCTION

	Address	Units
1	The Marquee	36
2	The Darien	212
3	New Fairmount Manor	404
4	8th & Spring Garden Street	146
5	501 Spring Garden Street	373
6	418 Spring Garden Street	329
7	800-808 Callowhill Street	220

8	5th & Callowhill Street	220
9	412 N 2nd Street	397
10	300 N Christopher Columbus Blvd.	360
11	Festival Pier Apartments	550
12	200 Spring Garden Street	355
13	826 2nd Street	78
14	346 W Girard Avenue	50
15	1102 Germantown Avenue	169
16	Piazza Terminal	1,131
17	1075 Germantown Avenue	697
18	1130-1154 N Delaware Avenue	269
19	1100 Delaware Avenue	169
20	Welhaus	

FOR LEASE: RETAIL/FLEX SPACE AVAILABLE

4,000 SF - 8,000 SF

914 Canal Street | Northern Liberties | Philadelphia, PA

EQUITY CRE



Demographic Overview (0.25, 0.50, 1-mile radius)

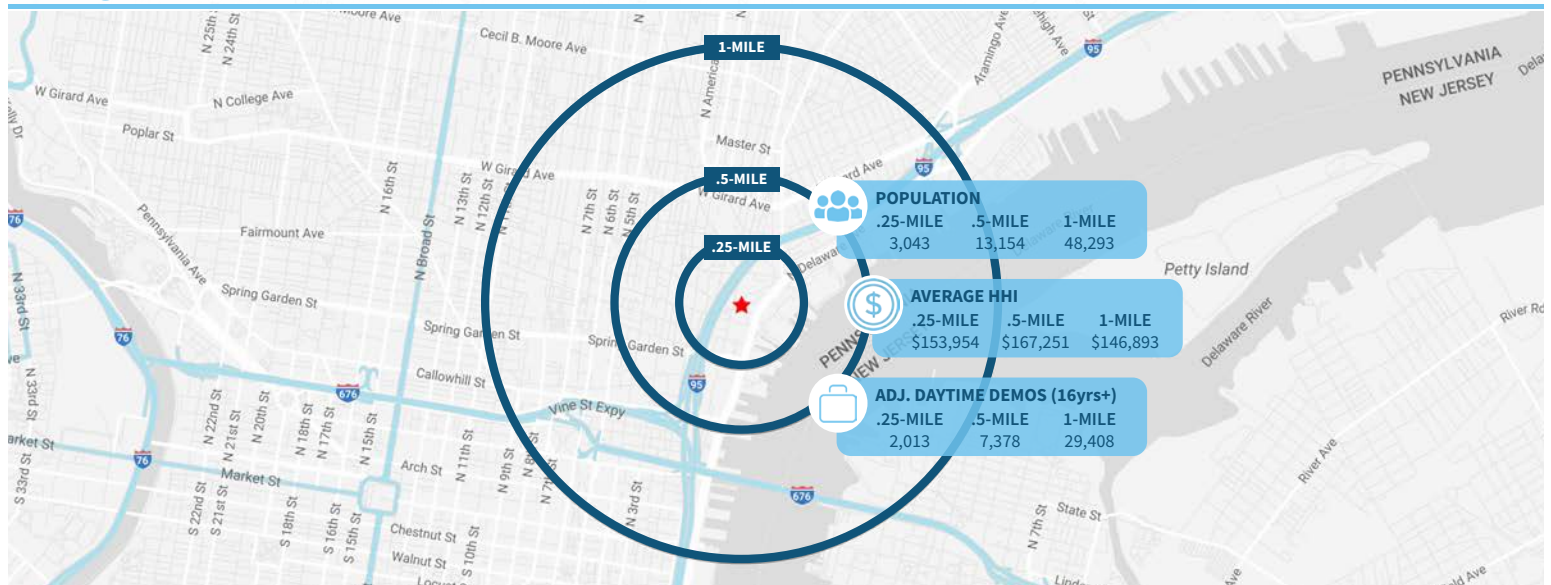

FOR LEASE: RETAIL/FLEX SPACE AVAILABLE

4,000 SF - 8,000 SF

914 Canal Street | Northern Liberties | Philadelphia, PA

EQUITY CRE

FLOOR PLANS

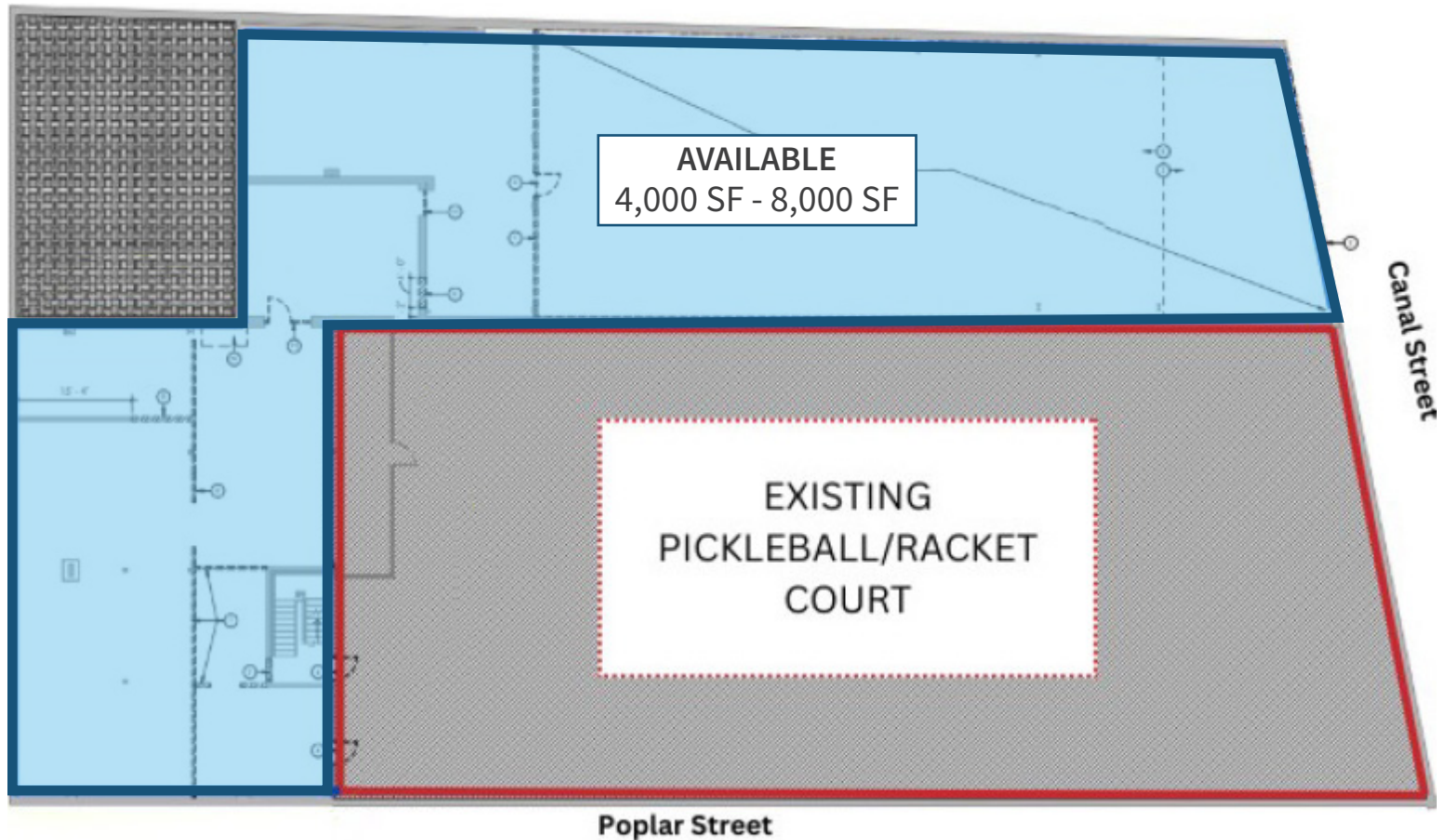

The right space. The right move.



CMRE CAPITAL MARKETS
REAL ESTATE NETWORK

Information concerning this offering is from sources deemed reliable but no warranty is made to the accuracy thereof and it is submitted subject to errors, omissions, changes of price or other conditions, prior to sale or lease or withdrawal without notice. Equity CRE is licensed in PA, NJ, & DE. Steve Jeffres, Nathan Rhodes & Chris Mundiath are licensed salespersons in PA.

08/25

RETAIL AERIAL



Aerial Source: Google Earth Pro & Traffic Count Source: Regis Online (24)