

FOR LEASE: FLEX/LIGHT INDUSTRIAL SPACE

2501 Wharton Street, Philadelphia, PA

EQUITY CRE



PROPERTY HIGHLIGHTS

- 2 spaces available
 - Unit C: 17,100 SF
 - Unit R: 3,500 SF
- On site parking
- Join Central Bark, The Rounds, Urban Jungle & many more

LOCATION DETAILS

- Located within minutes of University City, Washington Ave & I-76 Corridor
- Equidistant from South Philadelphia & University City

CONTACT

CONOR TUNNO

ctunno@equitycre.com

DIRECT 484.531.2004

STEVE JEFFRIES

sjeffries@equitycre.com

DIRECT 484.531.2250

FOR LEASE: FLEX/LIGHT INDUSTRIAL SPACE

2501 Wharton Street, Philadelphia, PA

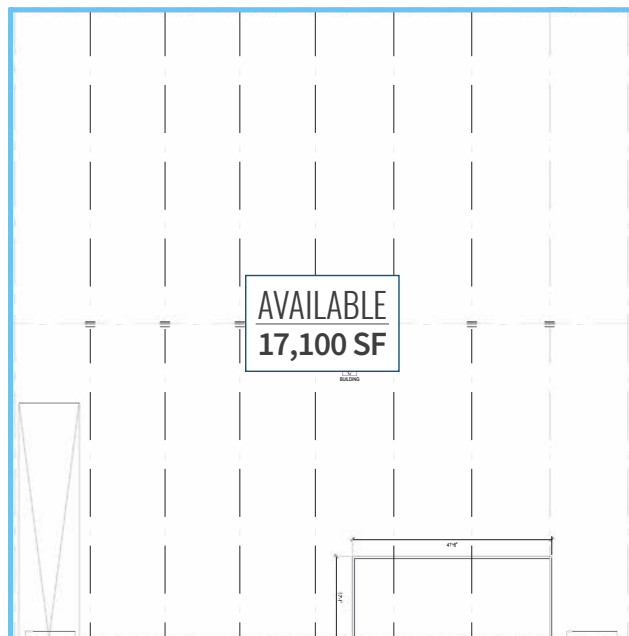
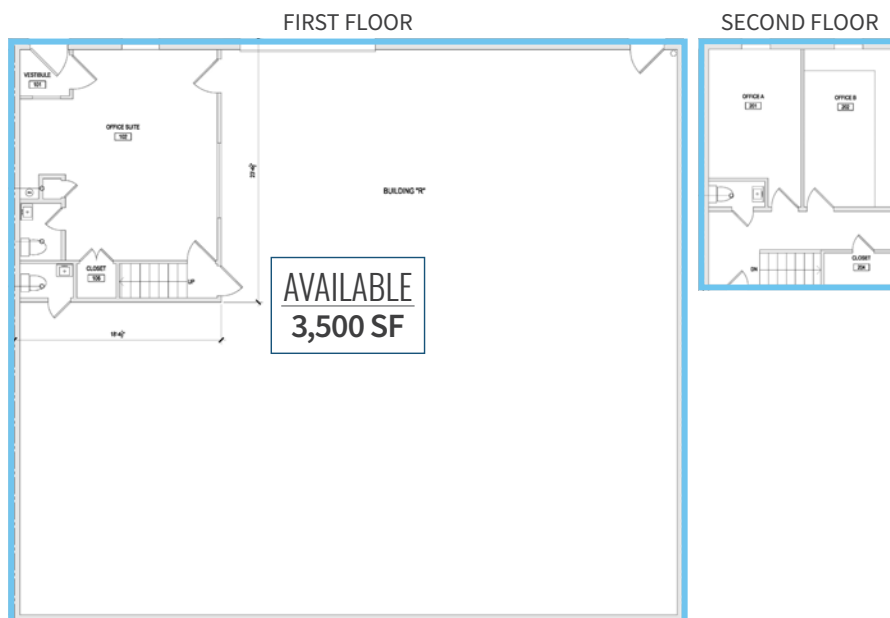
EQUITY CRE**FLOOR PLANS****UNIT C****UNIT R****Demographic Overview (.25, .5, 1-mile radius)****The right space. The right move.****CMRE** CAPITAL MARKETS
REAL ESTATE NETWORK

Information concerning this offering is from sources deemed reliable but no warranty is made to the accuracy thereof and it is submitted subject to errors, omissions, changes of price or other conditions, prior to sale or lease or withdrawal without notice. Equity CRE is licensed in PA, NJ, & DE. Conor Tunno & Steve Jeffries are licensed salespersons in PA.

05/25

RETAIL AERIAL

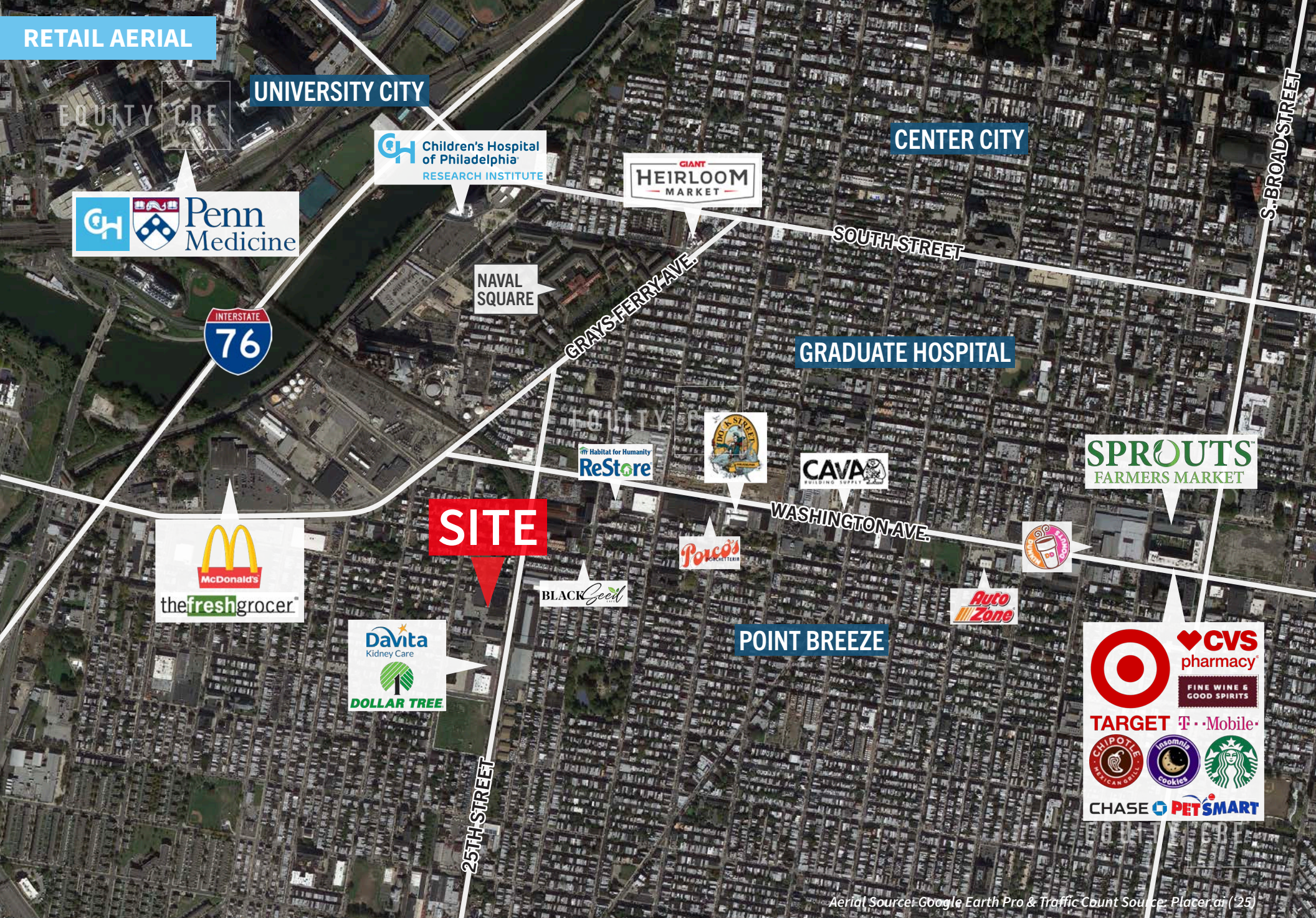

Aerial Source: Google Earth Pro & Traffic Count Source: Placer.ai ('25)

Compliments of:

EQUITY CRE

Plymouth Meeting, PA ■ Philadelphia, PA ■ 610.645.7700 ■ www.equitycre.com