

## FOR LEASE: FLEX/LIGHT INDUSTRIAL SPACE

2501 Wharton Street, Philadelphia, PA

EQUITY CRE



### PROPERTY HIGHLIGHTS

- 3 spaces available
  - Unit C: 17,100 SF
  - Unit P: 5,404 SF
  - Unit R: 3,500 SF
- On site parking
- Join Central Bark, The Rounds, Urban Jungle & many more

### LOCATION DETAILS

- Located within minutes of University City, Washington Ave & I-76 Corridor
- Equidistant from South Philadelphia & University City

### CONTACT

CONOR TUNNO

ctunno@equitycre.com

DIRECT 484.531.2004

STEVE JEFFRIES

sjeffries@equitycre.com

DIRECT 484.531.2250

**FOR LEASE: FLEX/LIGHT INDUSTRIAL SPACE**

2501 Wharton Street, Philadelphia, PA

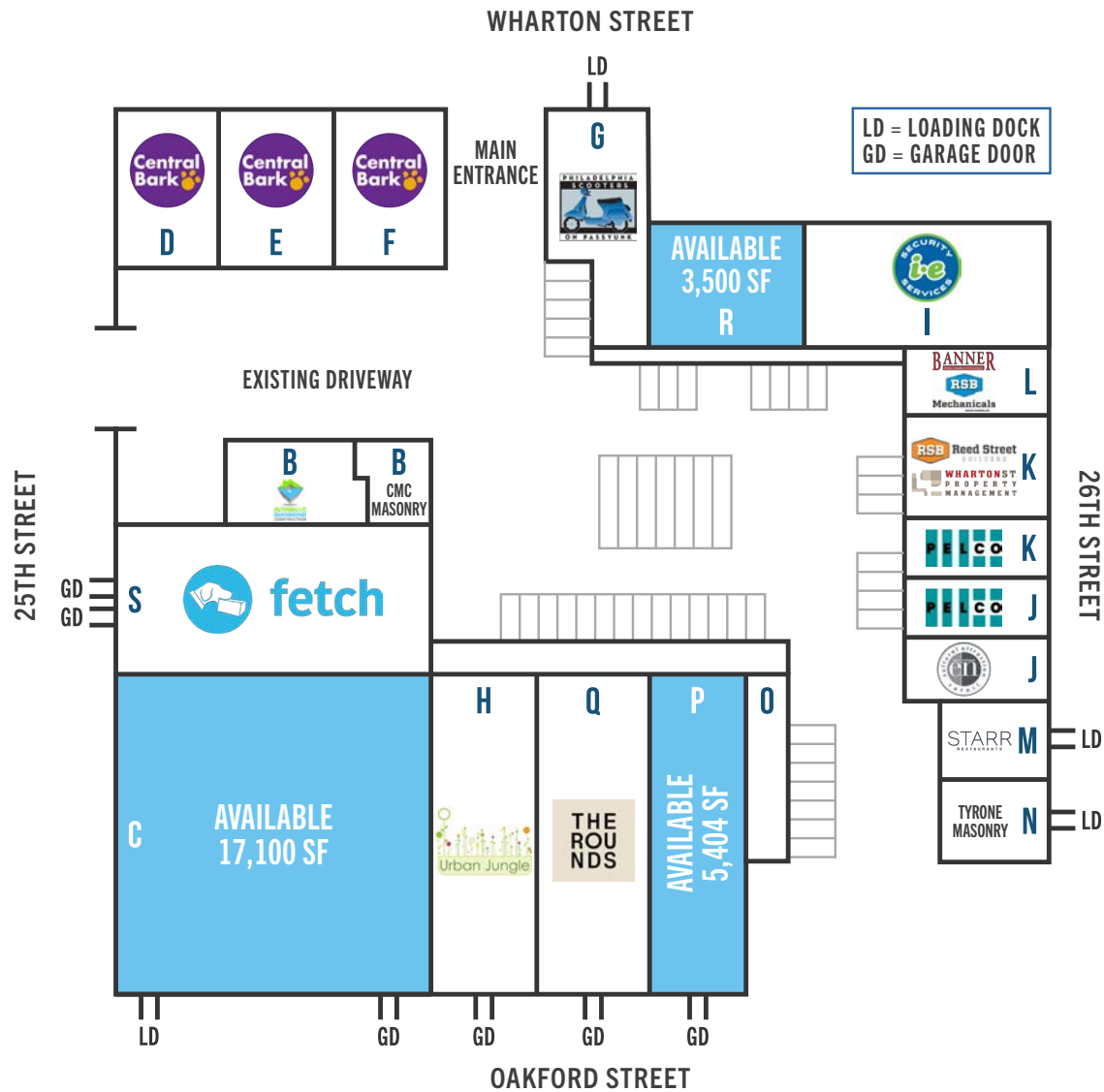
**EQUITY CRE**

BLDG.	TENANT	SF
B-Front Garage	CMC Masonry	
B-1 <sup>st</sup> & 2 <sup>nd</sup> Floor Office & Rear Garage	Altobello Giannone	
<b>C - Garage</b>	<b>AVAILABLE</b>	<b>17,100 SF</b>
D,E,F	The Dog's Wish	
G-Garage	Philadelphia Scooter	
H-Garage	Urban Jungle	
I-Garage	Imperial Event Security	

BLDG.	TENANT	SF
J-Garage	Event Network	
J-1 <sup>st</sup> & 2 <sup>nd</sup> Floor Office & K Garage	Pelco	
K-1 <sup>st</sup> & 2 <sup>nd</sup> Floor Office	Reed St Builders	
K-1 <sup>st</sup> Floor Office	Wharton St Property Management	
L-Garage	RSB Mechanicals	
L-2 <sup>nd</sup> Floor Office	Banner Promotions	

BLDG.	TENANT	SF
M-Garage	Starr Restaurant Group	
N-Garage	Tyrone Masonry	
O-Garage	Louis Pollutri	
<b>P-Garage</b>	<b>AVAILABLE</b>	<b>5,404 SF</b>
Q-Garage	The Rounds	
<b>R-Garage</b>	<b>AVAILABLE</b>	<b>3,500 SF</b>
S-Garage	Fetch	

## FOR LEASE: FLEX/LIGHT INDUSTRIAL SPACE

2501 Wharton Street, Philadelphia, PA

EQUITY CRE

### FLOOR PLANS



UNIT C

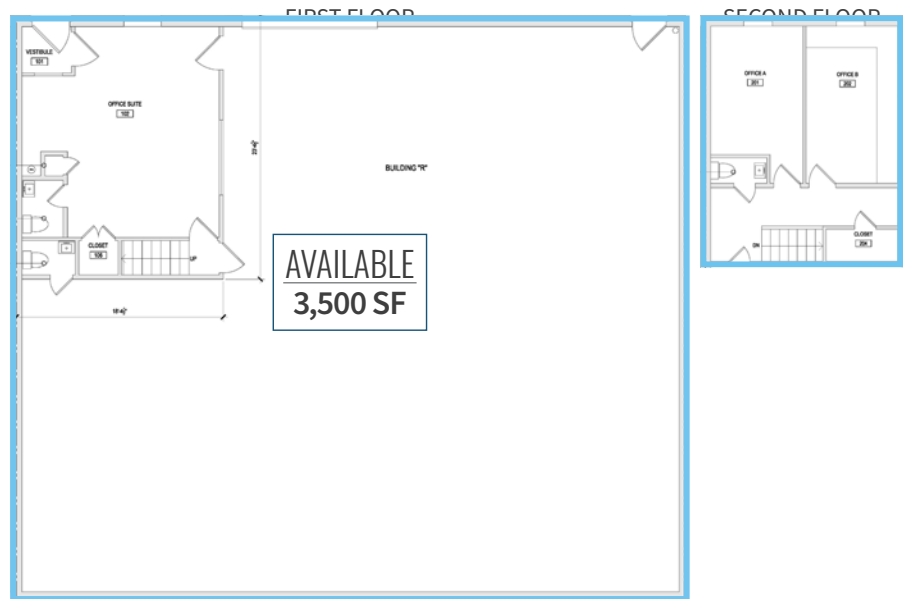

UNIT R

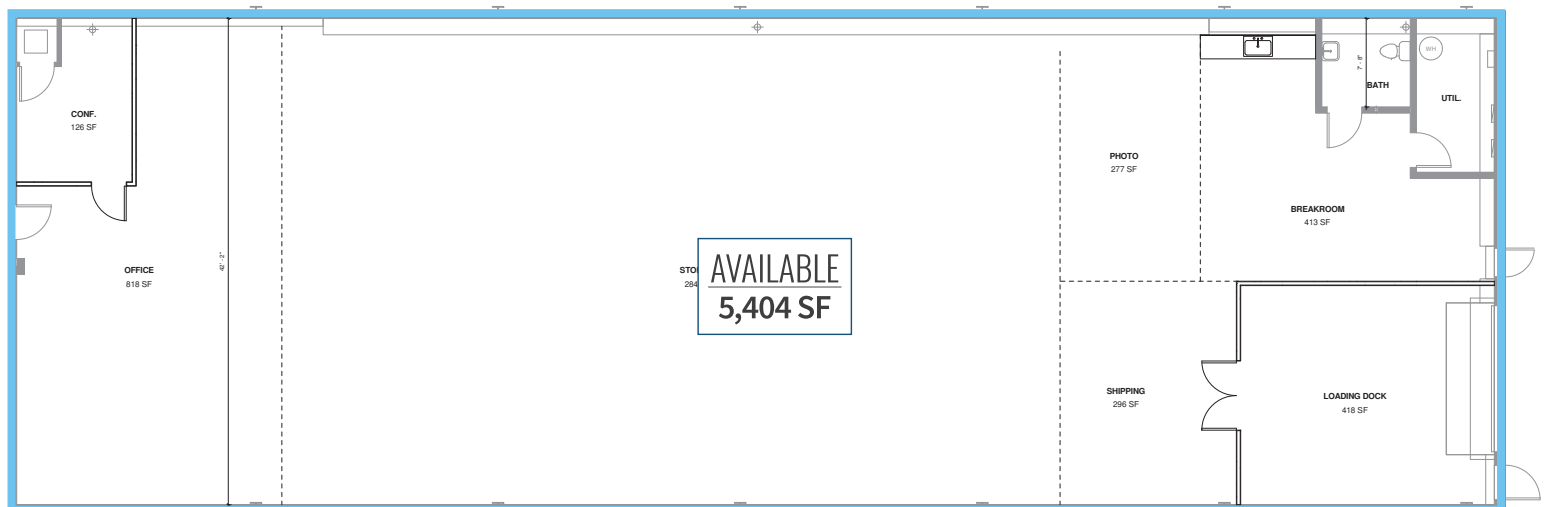

UNIT P



**FOR LEASE: FLEX/LIGHT INDUSTRIAL SPACE**

2501 Wharton Street, Philadelphia, PA

**EQUITY CRE****Demographic Overview (.25, .5, 1-mile radius)****The right space. The right move.****CMRE** CAPITAL MARKETS  
REAL ESTATE NETWORK

Information concerning this offering is from sources deemed reliable but no warranty is made to the accuracy thereof and it is submitted subject to errors, omissions, changes of price or other conditions, prior to sale or lease or withdrawal without notice. Equity CRE is licensed in PA, NJ, & DE. Conor Tunno & Steve Jeffries are licensed salespersons in PA.

05/25



# RETAIL AERIAL

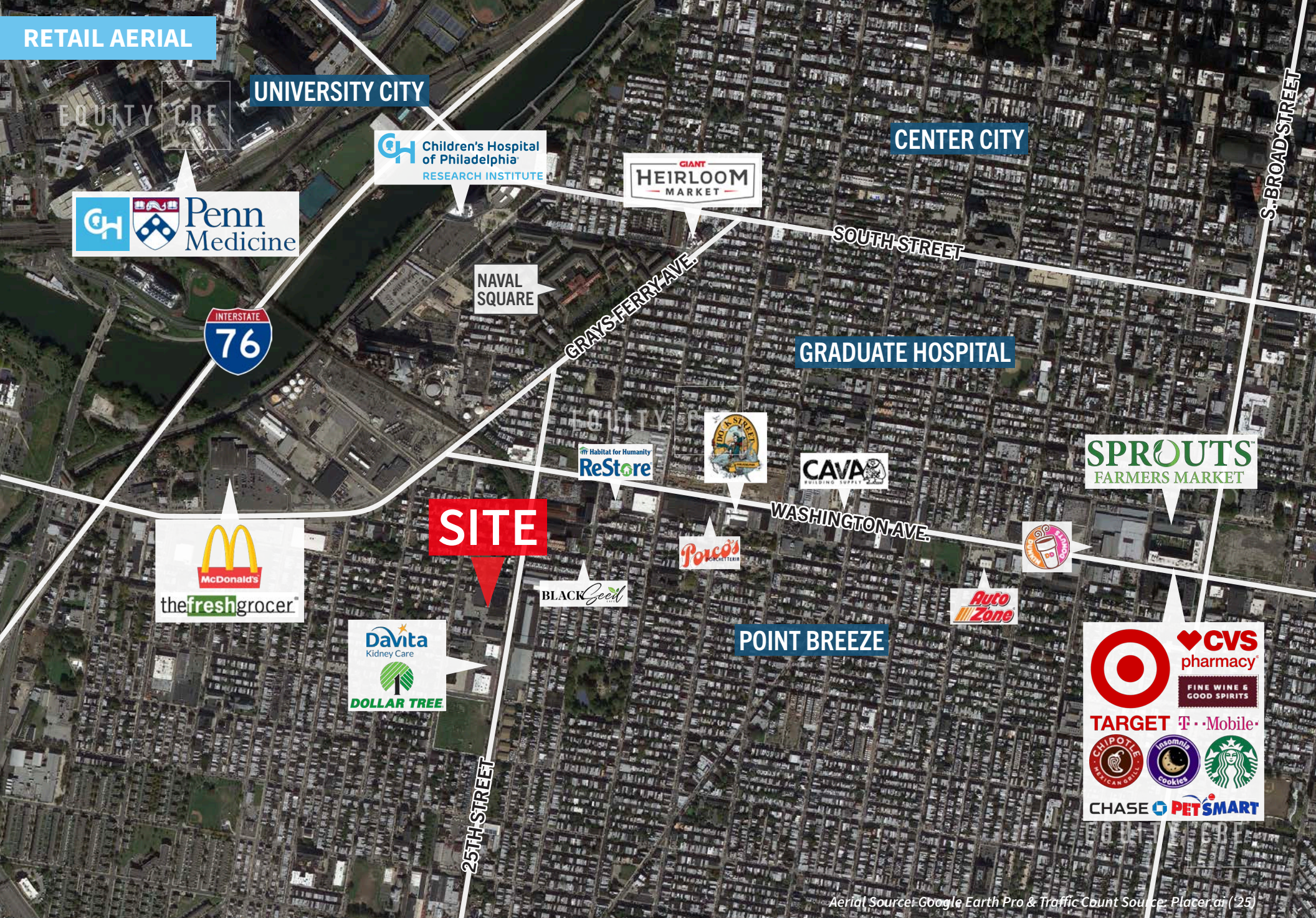

Aerial Source: Google Earth Pro & Traffic Count Source: Placer.ai ('25)

Compliments of:

EQUITY CRE

Plymouth Meeting, PA ■ Philadelphia, PA ■ 610.645.7700 ■ [www.equitycre.com](http://www.equitycre.com)